

●STUD TYPE

TEST TERMINALS



B-TYPE

STANDARD MODELS

B-PTT

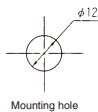
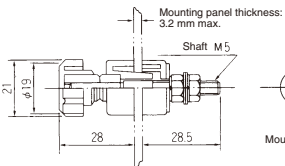

B-CTT

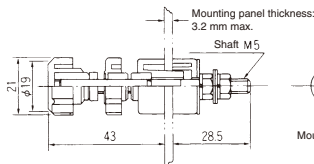

ACCESSORIES

Protective cover (Front)

●B-C

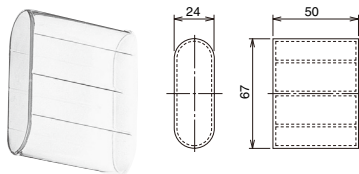

* B-C is applicable when test terminals are mounted at pitches of 40 mm.
If the B-LB short bar is mounted, B-C cannot be used.

Protective cover (back)

●B-CVB

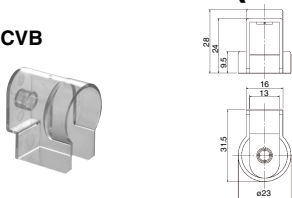

Color rings

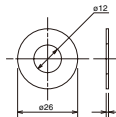

Color	Model
Blue	B color ring BL
White	B color ring W
Red	B color ring R
Yellow	B color ring Y
Black	B color ring B
Green	B color ring G

(Ordering unit: 100 pieces)

Jumper

●B-SV

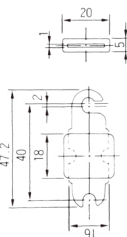

Model	Code	Munsell color
B-SV	4/1.5	7.5BG4/1.5
	3/3.5	7.5BG3/3.5
	R	7.5R4.5/14
	Y	2.5Y8/12
	B	N1.5

●B-SB

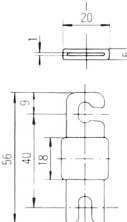

Model	Code	Munsell color
B-SB	4/1.5	7.5BG4/1.5
	3/3.5	7.5BG3/3.5
	R	7.5R4.5/14
	Y	2.5Y8/12
	B	N1.5

●B-LB

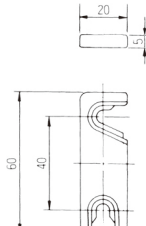

Model	Code	Munsell color
B-LB	4/1.5	7.5BG4/1.5
	3/3.5	7.5BG3/3.5
	R	7.5R4.5/14
	Y	2.5Y8/12
	B	N1.5

EXAMPLES OF CONNECTION

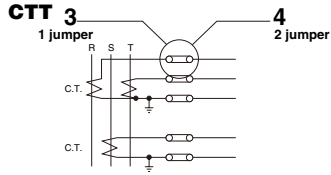
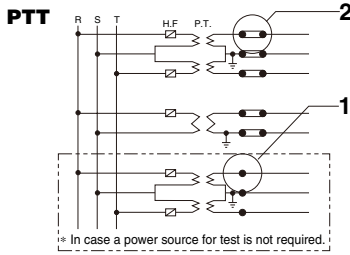

H.F ... High-voltage fuse
 P.T ... Transformer for instruments
 C.T ... Current transformer for instruments

1

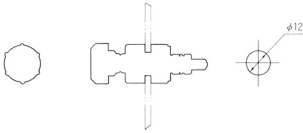

2

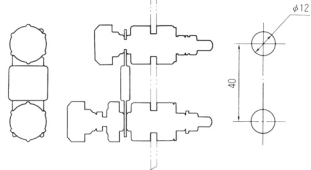
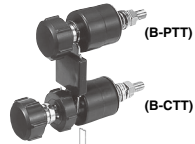

3

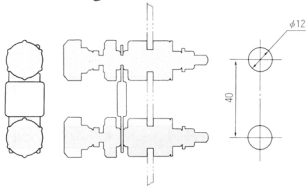

4

